

Series HI3100 & 3400 4" Frame Depth
HURRICANE-RESISTANT DOUBLE HUNG • Tilt Sash

OPERATION

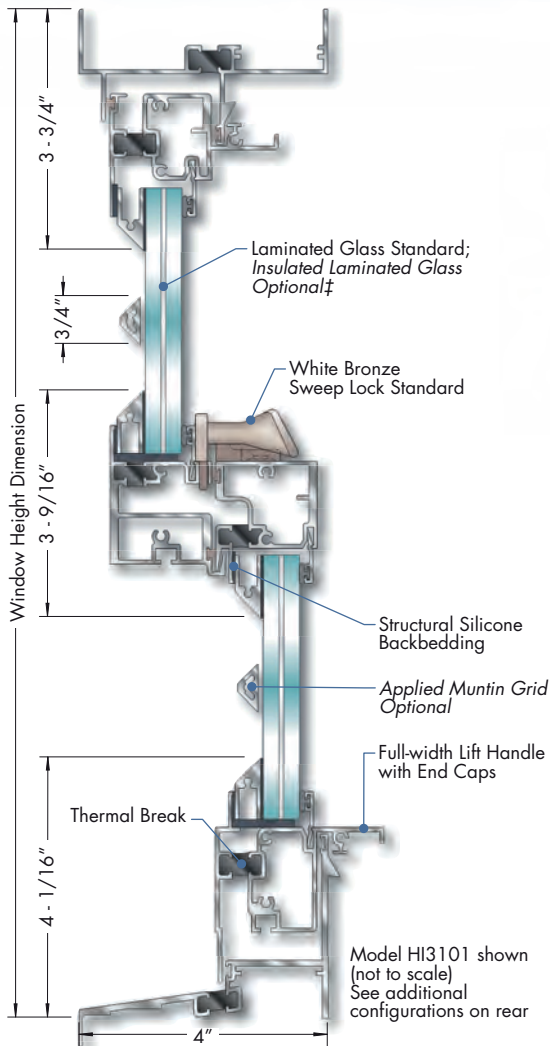

Shingle Creek, Orlando, FL



Shell Point, Ft. Myers, FL

STANDARD FEATURES

- Double-hung tilt-sash windows for hurricane-impact resistance
- Provides large missile impact protection
- Offers passive protection from wind-borne debris - without shutters!
- Thermally broken frame and sash for superior energy savings
- Mulls to fixed and operable products of the same frame depth
- Class 5 Ultra-Lift™ or block & tackle balances for superior operation
- Tilt sash for ease of cleaning; custodialy-operated release mechanism
- Full-length extruded lift handles
- Utilizes durable white bronze sweep lock at meeting rail
- Patented integral anti-bow feature in jambs & stiles

INSTALLATION METHODS

- Pre-set panning
 - Trim & clip*
 - Wraparound panning*
 - Receptor & subsill*
- * Currently approved

OPTIONS

- Historic grids
- Blast resistant

HURRICANE-RESISTANT SERIES HI3100 & HI3400 DOUBLE HUNG • Tilt Sash

Operation	Type	Frame Depth	Series	Model Code	Glazing‡	Missile Type		Florida Product Approval		Design Pressure [PSF]		Water Test Pressure [PSF]	Test Size in Inches
						Large	Small	Number	HVHZ	POS [+]	NEG [-]		
	Double Hung Tilt Sash	4"	HI-3100	HI3101	Single Lami	✓	Meets	FL10083.4	✓	70	100	10.5	38 x 73-1/2
	Double Hung Tilt Sash	4"	HI-3400	HI3401	Single Lami		✓	FL10083.6	✓	70	100	10.5	48 x 72
				HI3402	Single Lami	✓	Meets	FL10083.5	✓	50	75	10.5	48 x 72

The information on this page is current at the time of publication. ‡Additional glazing & test configurations available - call Graham.

Series HI3100 & HI3400 DOUBLE HUNG • Tilt Sash INFORMATION

- Materials:
All frame and sash sections shall be thermally broken extruded aluminum shapes produced from commercial quality 6063-T5 alloy
- Hardware:
Class 5 Ultra-Lift™ or block & tackle balances for easiest sash operation - even on largest sizes
White bronze sweep locks for strength and extra durability
Tested to impact performance standards
- Finish Options:
AAMA 2603, 2604, & 2605, as well as powder coat and anodized finishes, are all available in a wide range of colors
- Accessories:
Wide range of panning & trim options available

! Check website for complete, current information including other installation and hardware options: www.grahamwindows.com
 1551 Mt. Rose Avenue, York, Pennsylvania 17403-2909 • e-mail: info@grahamwindows.com • 800-755-6274 • 717-849-8100



Vertical Cross Section *(Not to scale)*

HI3401

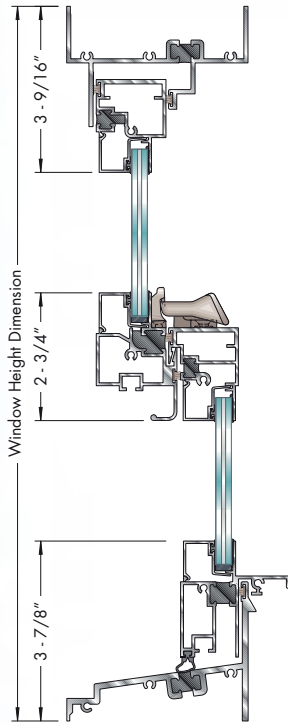

HI3402

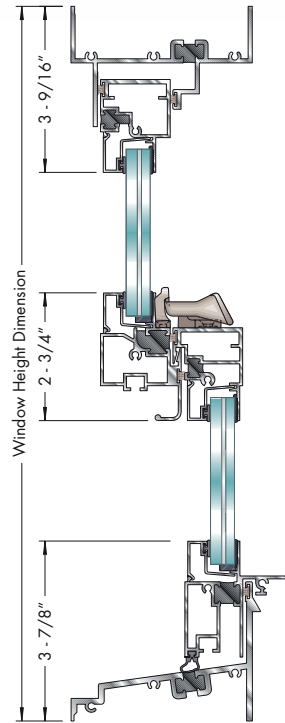

Horizontal Cross Section at Left Jamb *(Not to scale)*

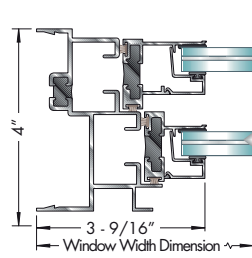
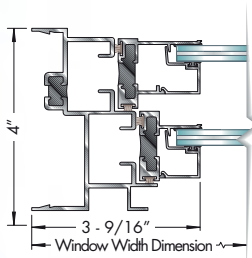

HI3401 Features

- Double-hung window with tilt-in sash
- Thermal-break frame and sash
- Single-glazed laminated glass
- Small missile +70/-100 DP performance

HI3402 Features

- Double-hung window with tilt-in sash
- Thermal-break frame and sash
- Single-glazed laminated glass
- Large missile +50/-75 DP performance

*PLEASE NOTE: The illustrations shown are informational only as anchorage requirements vary widely according to application, product size, and performance constraints. Contact Graham's Technical Services Department at 800-755-6274 for project application assistance.

Graham

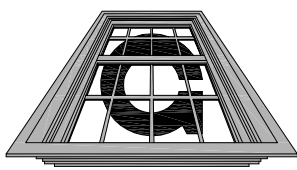

Architectural Products

Hurricane Impact - 4"

Double Hung Tilt

Tested To +70DP/-100DP (Large Missile)

Series: HI3100

Manufacturing Code: HI3101

Drawing 1/2 Scale - For Custom Size Drawing Contact Graham

Note: Sealant Not Shown On Details. Consult Technical Services At Factory For Sealing Procedures.

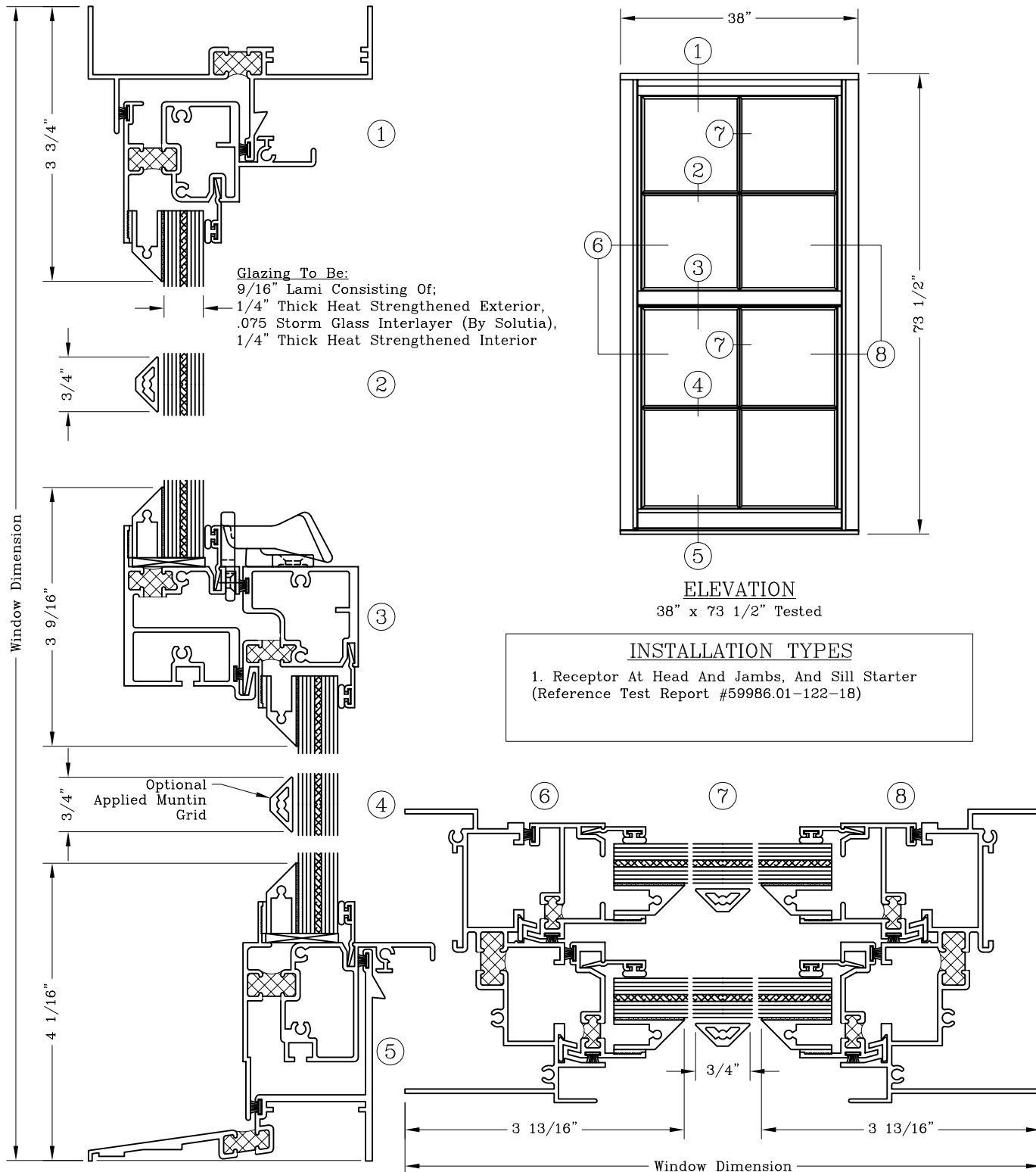

Graham

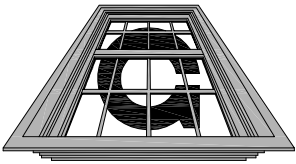

Architectural Products

Hurricane Impact - 4"

Double Hung Tilt

Tested To +50DP/-75DP (Large Missile)

Series: HI3400

Manufacturing Code: HI3401

Drawing 1/2 Scale - For Custom Size Drawing Contact Graham

Note: Sealant Not Shown On Details. Consult Technical Services At Factory For Sealing Procedures.

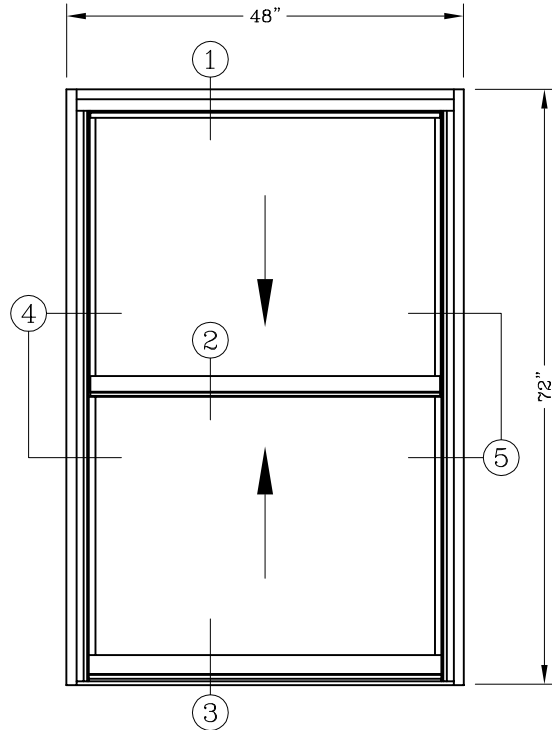
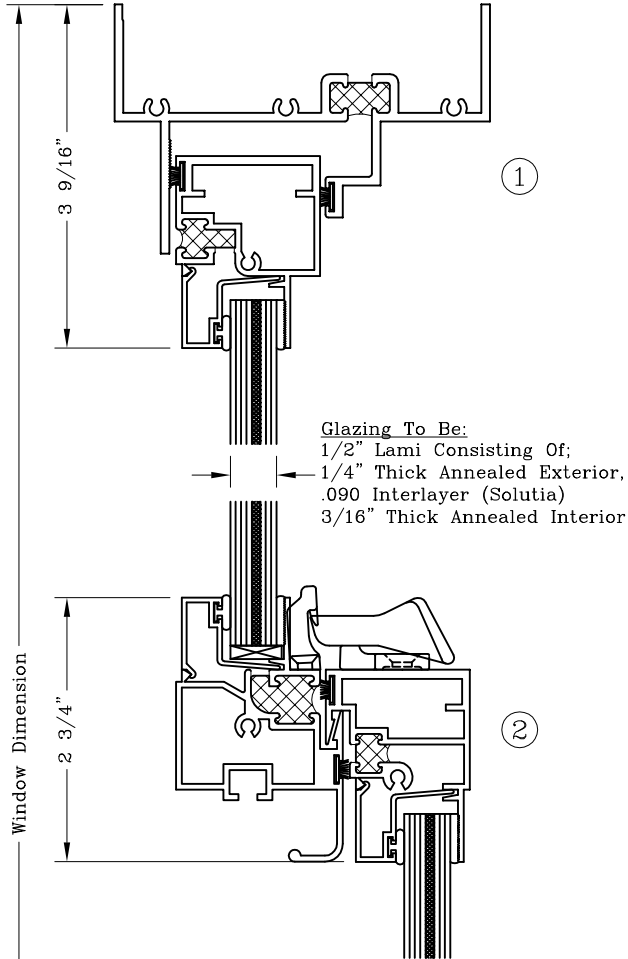

ELEVATION

48" x 72" Tested

INSTALLATION TYPES

- 1. Trim And Clip
(Reference Test Report #01-46930.01)

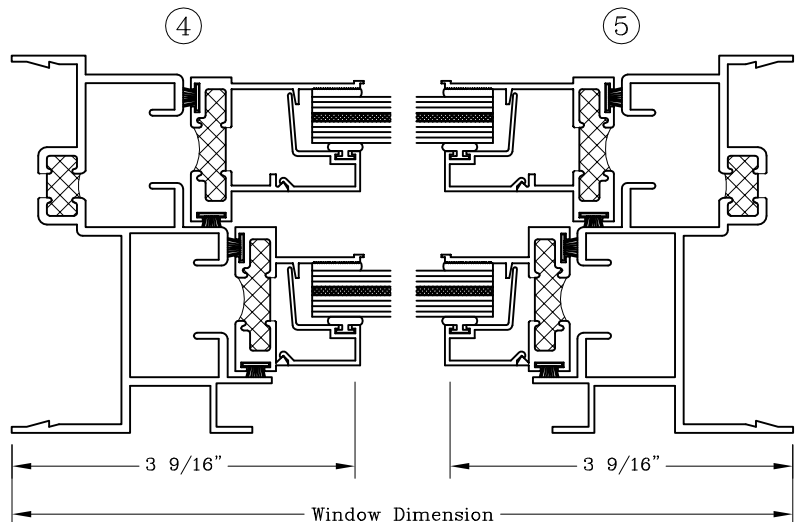
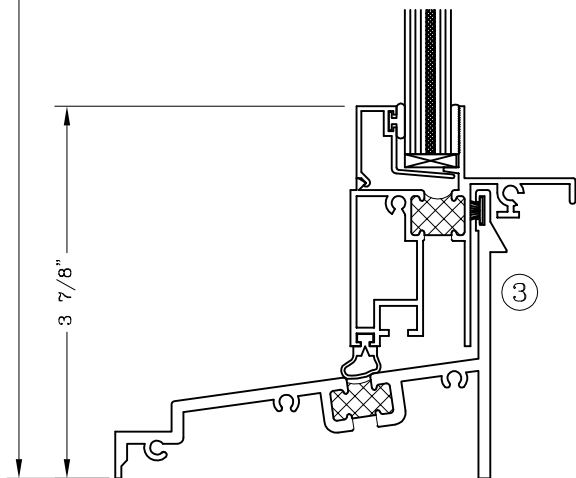

Graham

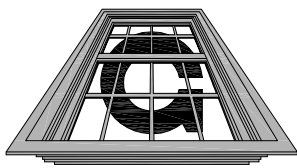

Architectural Products

Hurricane Impact - 4"

Double Hung Tilt

Tested To +70DP/-100DP (Small Missile)

Series: HI3400

Manufacturing Code: HI3402

Drawing 1/2 Scale - For Custom Size Drawing Contact Graham

Note: Sealant Not Shown On Details. Consult Technical Services At Factory For Sealing Procedures.

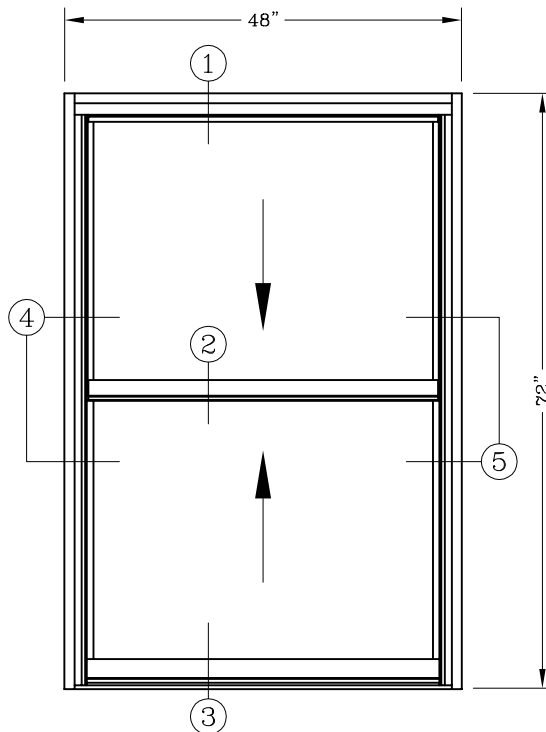
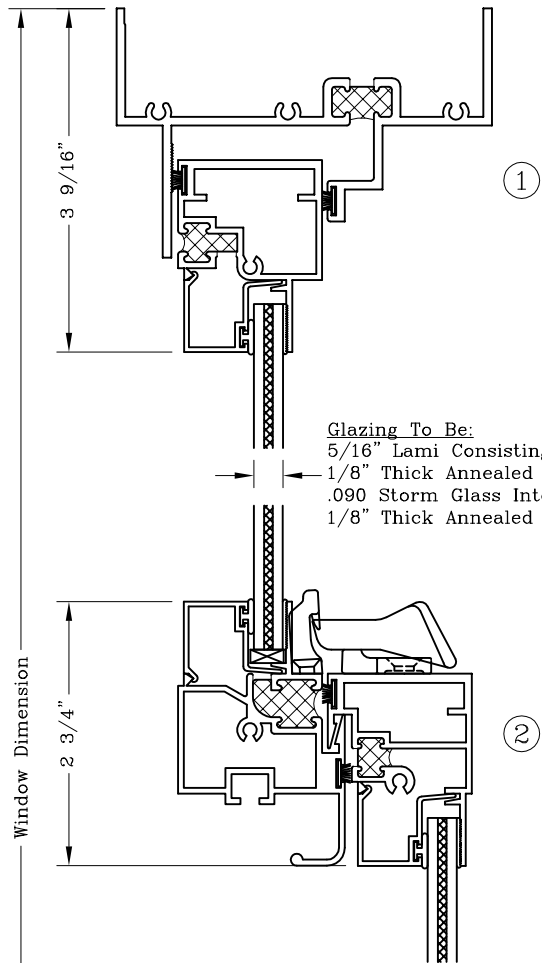

ELEVATION

48" x 72" Tested

INSTALLATION TYPES

1. Trim And Clip
(Reference Test Report #01-46853.02)

