

B1400H SERIES DATA SHEET

SHOCK TUBE TESTED • THIRD PARTY EVALUATION • MANUFACTURED IN THE USA

WINDOW TYPE	FRAME DEPTH (inches)	SERIES	DESIGNED BLAST PRESSURE (psi)	POSITIVE PHASE IMPULSE (psi-msec)	WINDOW SIZE (inches)	GLAZING COMPOSITION (inches)	TESTING & CERTIFICATIONS		
							Test Methods	Qualified	Certification
Aluminum Fixed Historic	4	B1400H	6.7	47	48 x 66	$\frac{3}{16}$ annealed, $\frac{17}{32}$ as, $\frac{1}{4}$ lami	ASTM F 1642	ASTM "Minimal Hazard" GSA Condition 2 UFC 4-010-01	Independent Test Report

Products comply with Unified Facilities Criteria UFC 4-010-01; DoD Minimum Antiterrorism Standards for Buildings

STANDARD FEATURES

- Fixed windows for blast mitigation
- Provides GSA level C protection against explosive attacks
- Meets DoD UFC 4-010-01 criteria
- Mulls to 4" frame fixed and operable products
- Trim & clip or receptor anchoring system
- 1" insulating glass construction using industry standard laminated technology

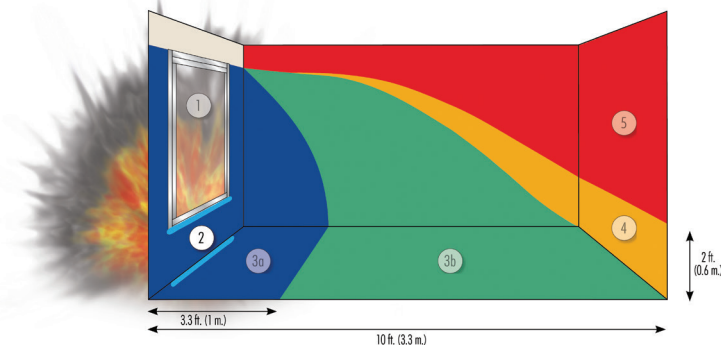
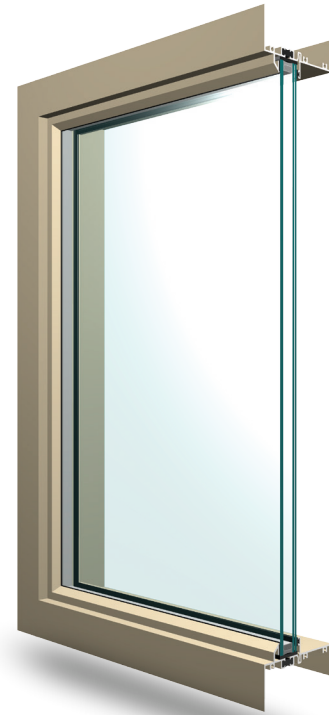

Series B1400H Meets GSA Condition 2

Window series: B1400H Fixed — General Specifications & Details

- Nominal Frame/Sill Wall Thickness: 0.062/.078"
- Test Size: 50" x 68"
- Glazing: $\frac{1}{4}$ " annealed, $\frac{1}{2}$ " spacer, $\frac{1}{4}$ " laminated
- Mullins: Exterior-applied or between IG muntin grids available
- Radius shapes or custom curving to specification

- Finish Options:
 - AAMA 2603 — Standard acrylic or polyester
 - AAMA 2604 — 2 coat 50% fluoropolymer
 - AAMA 2605 — 2 coat fluoropolymer 70% kynar
 - Powder Coat
 - Anodized
- Accessories:
 - Frame Family: 4"
 - Mullions: Stacking: Integral & fixed-stack mull
 - Side: 3-piece mull
 - Panning: Available
 - Trims: Available
 - Receptor Systems: Available
- Exceptions: Call Graham sales rep or see website for more information

Our products are tested to the standards of and certified by the American Architectural Manufacturer's Association and the National Fenestration Rating Council.



Blast Mitigation – 4” Fixed



Series: B1400

Manufacturing Code: B1402

Drawing 1/2 Scale – For Custom Size Drawing Contact Graham

Note: Sealant Not Shown On Details. Consult Technical Services At Factory For Sealing Procedures.

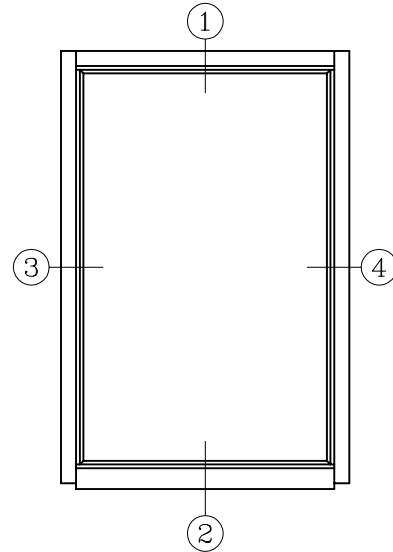
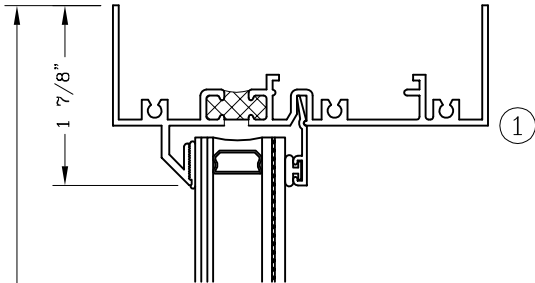

ELEVATION

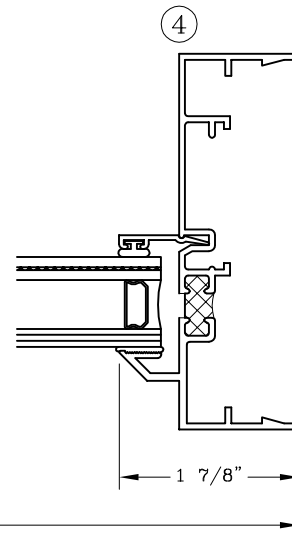
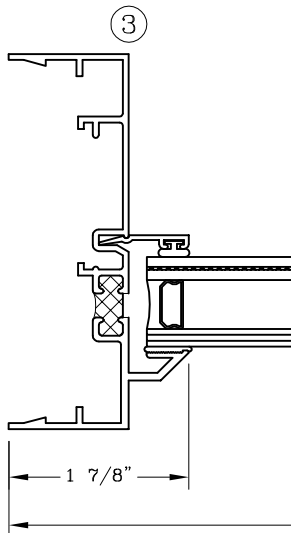
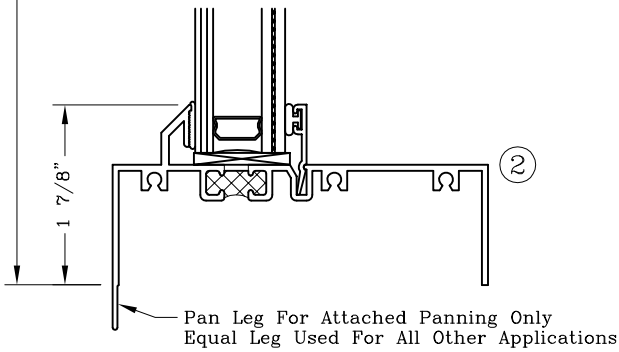

Window Dimension