

Exterior Profile Options 2 1/2" Frame – Flush Face



Series: GS6600FF Manufacturing Code: GS6613FFB

Drawing 1/2 Scale – For Custom Size Drawing Contact Graham

Note: Sealant Not Shown On Details. Refer To General Installation Instructions.

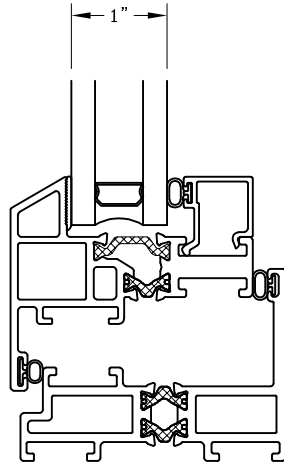

GS6600B
Beveled

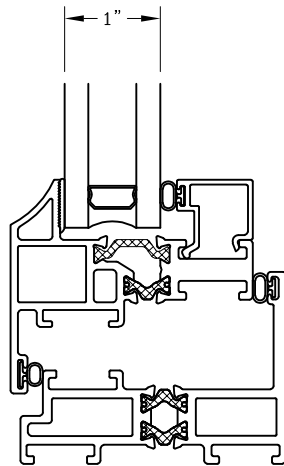

GS6600C
Concave

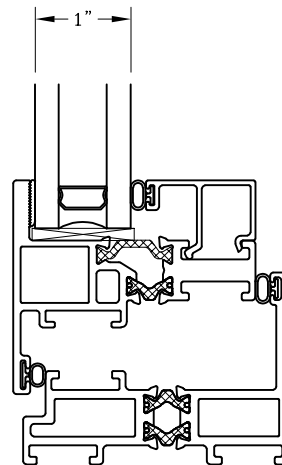

GS6600F
Flat

Note: Dashed Lines Represent Inswing Vented Units Solid Lines Represent
Outswing Vented Units; Lines Converge At Hinge Side Of Vent
Graham Architectural Products reserves the right to change, add, cancel, remove or otherwise modify the details illustrated without prior notice.

1551 Mt. Rose Avenue, York, Pennsylvania 17403-2909 717.849.8100 Toll Free: 800/755-6274

0223 – GS66.13FFB

Web Site: www.grahamwindows.com